

Assembly Instruction

Document No. 247852	Revision A				
Production state SERIES					
Preform Date 2011-05-31	Preform By TSN	Approved Date 2011-05-31	Approved By GHT	Page 1	

Mounting of Luggage basket

List of parts in the set.

Qty. 1. Luggage basket
 Qty. 1. Chassis bracket
 Qty. 1. Screw ISO 4762 M6x100 8.8 Fe/Zn 5 C1
 Qty. 2. Screw ISO 4762 M6x10 8.8 Fe/Zn 5 C1
 Qty. 3. Washer ISO 7089 6 200 HV Fe/Zn 5 C1
 Qty. 2. Threaded spacer

Qty. 1. Luggage basket holder
 Qty. 4. Screw ISO 4762 M6x16 8.8 Fe/Zn 5 C1
 Qty. 4. Screw ISO 4762 M5x10 8.8 Fe/Zn 5 C1
 Qty. 4. Washer 5 200 HV Fe/Zn 5 C1 (5,3x10x1)
 Qty. 4. Washer 6 200 HV Fe/Zn 5 C1 (6,4x12x1,6)

Read the instructions carefully before starting installation.

1. Remove the two screws holding the rear lights and the screw at the centre of the lower cover. See fig.

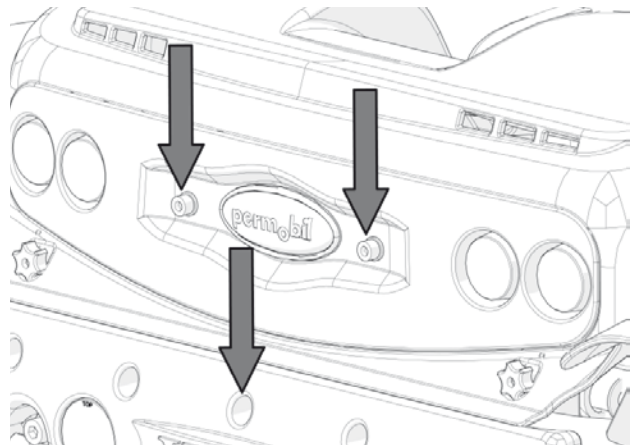

Remove existing screws.

2. Mount the attached threaded spacers. See fig.

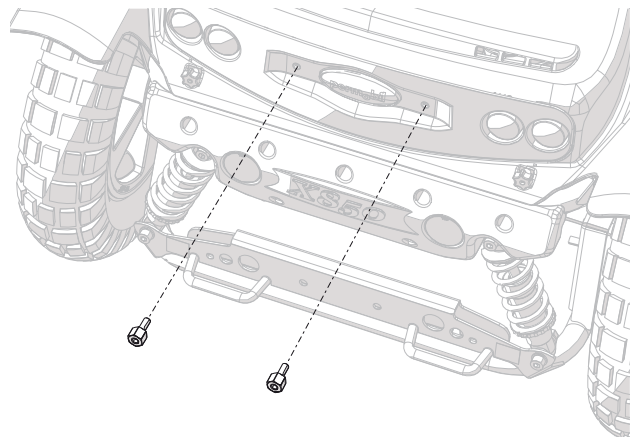

Mount the two threaded spacers.

Assembly Instruction

Document No. 247852	Revision A				
Production state SERIES					
Preform Date 2011-05-31	Preform By TSN	Approved Date 2011-05-31	Approved By GHT	Page 2	

3. Mount the chassis bracket with attached screws M6x12 and washers 6,4x12x1,6 on the threaded spacers and screw M6x100 with washer 6,4x12x1,6 at the centre of the lower cover. See fig.
4. Verify how far forward the luggage basket can be mounted by measuring the distance between the rear edge of the chassis bracket to the rear of the back rest. Have in mind the seat functions like seat swivel, seat tilt and back rest recline will have effect on the distance. Use all the seat functions and measure the distance when it's the shortest.

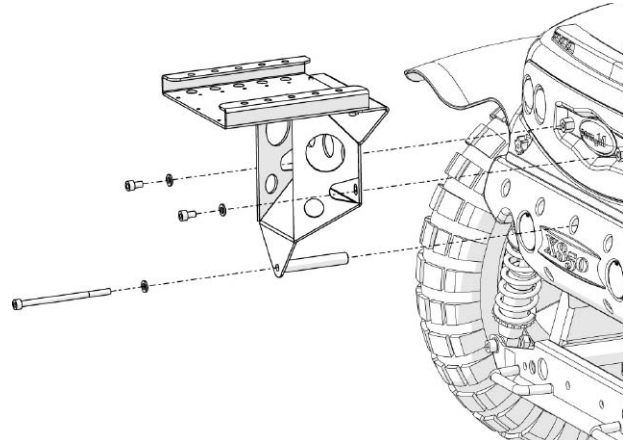

Mount the chassis bracket.

When mounting the luggage basket in standard position, the distance between the rear end of the chassis brackets to the front end of the luggage basket is approx. 60 mm. The distance can be adjusted from approx. 10 to 235 mm. by mounting in different positions. See paragraph 5-8.

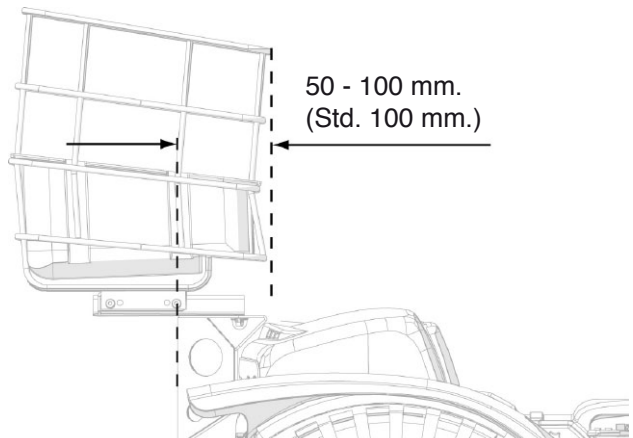

The position of the luggage basket can be adjusted.

5. Mount the luggage basket holder using the attached screws (M6x16). As standard, the luggage basket holder is mounted the most rear hole pattern. See fig.

To move the position of the luggage basket forward, move the luggage basket holder 1-2 steps forwards in the hole pattern. Each step moves the position of the luggage basket 25 mm.

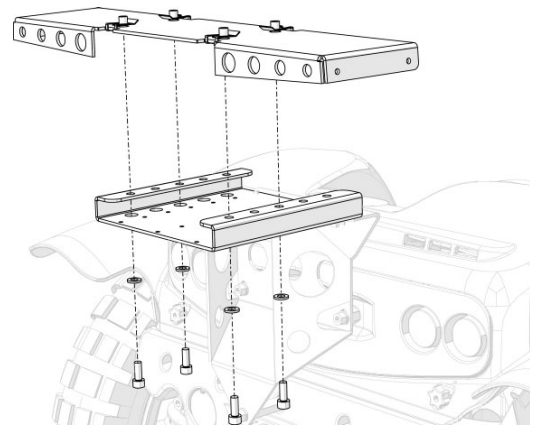

Mount the luggage basket holder on the chassis bracket.

Assembly Instruction

Document No. 247852	Revision A				
Production state SERIES					
Preform Date 2011-05-31	Preform By TSN	Approved Date 2011-05-31	Approved By GHT	Page 3	

6. Mount the luggage basket on the bracket using the attached screws (M5x10) and washers.

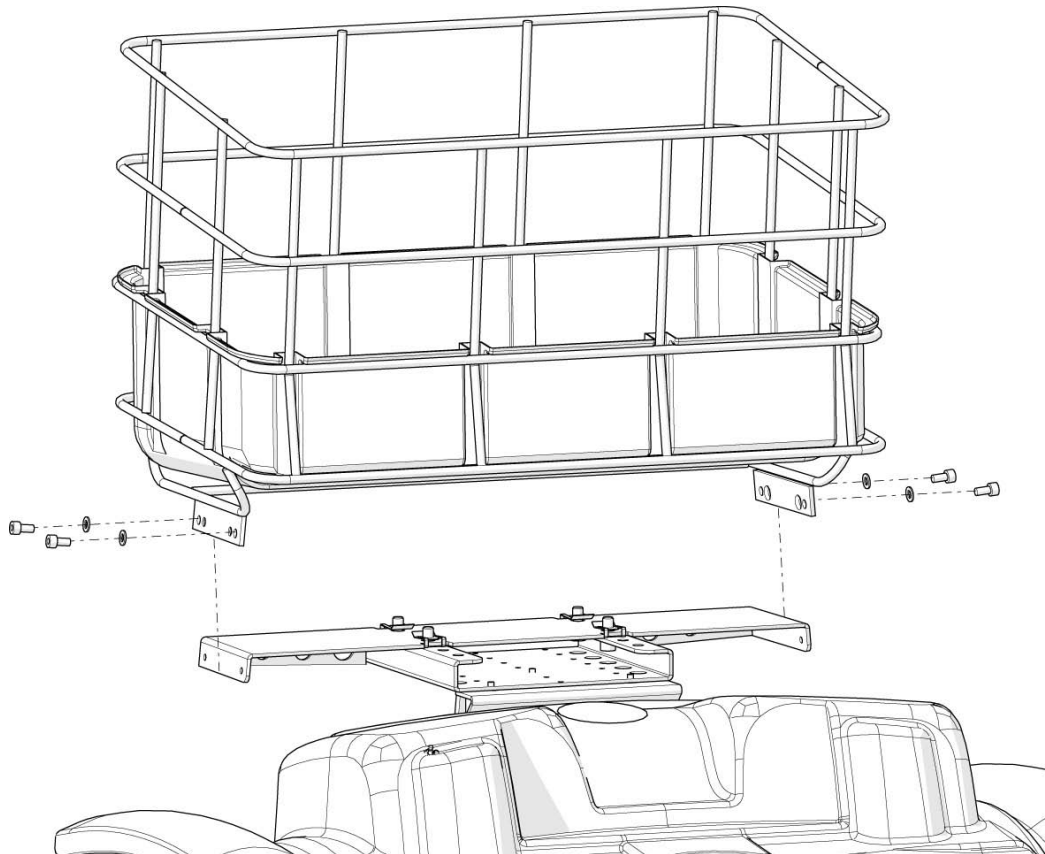

Mount the Luggage basket on the bracket.

Assembly Instruction

Document No. 247852	Revision A				
Production state SERIES					
Preform Date 2011-05-31	Preform By TSN	Approved Date 2011-05-31	Approved By GHT	Page 4	

Montering av Bagagekorg

Förteckning över detaljer som skall finnas i satsen.

1 st. Bagagekorg	1 st. Hållare för bagagekorg
1 st. Chassifäste	4 st. Skruv ISO 4762 M6x16 8.8 Fe/Zn 5 C1
1 st. Skruv ISO 4762 M6x100 8.8 Fe/Zn 5 C1	4 st. Skruv ISO 4762 M5x10 8.8 Fe/Zn 5 C1
2 st. Skruv ISO 4762 M6x10 8.8 Fe/Zn 5 C1	4 st. Bricka 5 200 HV Fe/Zn 5 C1 (5,3x10x1)
3 st. Bricka ISO 7089 6 200 HV Fe/Zn 5 C1	4 st. Bricka 6 200 HV Fe/Zn 5 C1 (6,4x12x1,6)
2 st. Gängad distans	

Läs noga igenom anvisningen *innan* montering påbörjas

1. Demontera de två skruvarna som håller bakljusrampen och den mittersta skruven på den nedre kåpan, se bild.

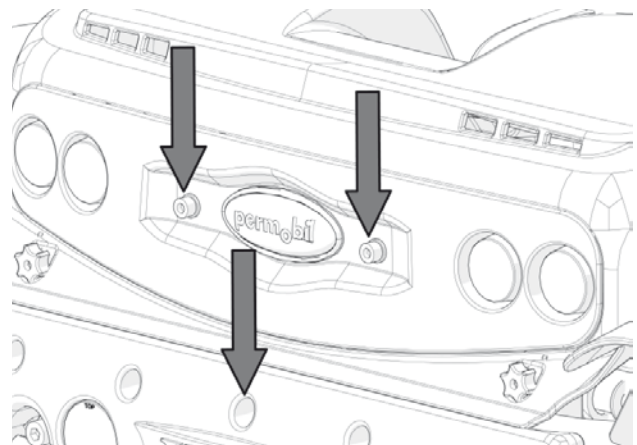

Demontera befintliga skruvar.

2. Montera de två medföljande gängade distanserna, se bild.

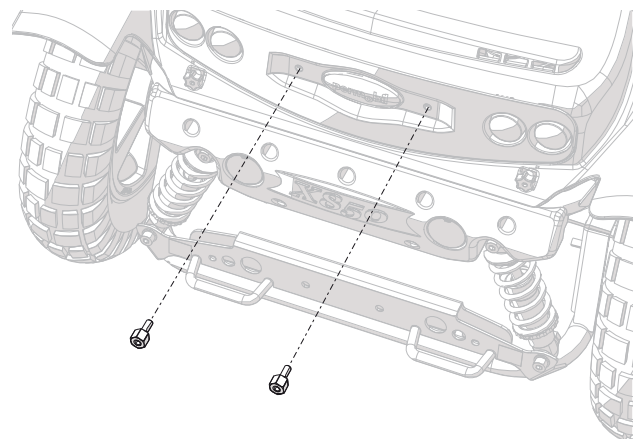

Montera de två gängade distanserna.

Assembly Instruction

Document No. 247852	Revision A				
Production state SERIES					
Preform Date 2011-05-31	Preform By TSN	Approved Date 2011-05-31	Approved By GHT	Page 5	

- Montera chassifästet med skruv M6x12 samt bricka 6,4x12x1,6 mot distanserna och skruv M6x100 med bricka 6,4x12x1,6 i nedre skruvhållet, se bild.
- Kontrollera hur långt fram bagagekorgen kan monteras genom att mäta avståndet från chassifästets bakkant till sitsens ryggstöd.

Tänk på att sitsens olika funktioner, som ex. sitsvridning, sitslutning och justerbart ryggstöd påverkar avståndet. Prova alla sitsfunktioner vid mätning och mät när avståndet är som minst.

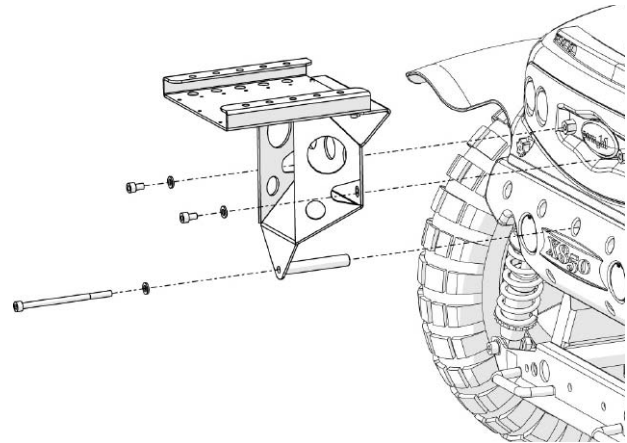

Montera chassifästet.

Vid montering av bagagekorgen i standardläge är avståndet från chassifästets bakkant till korgens framkant ca. 60 mm. Avståndet kan justeras från ca. 10-235 mm. genom montering i olika hålbilder, se punkt 5-8.

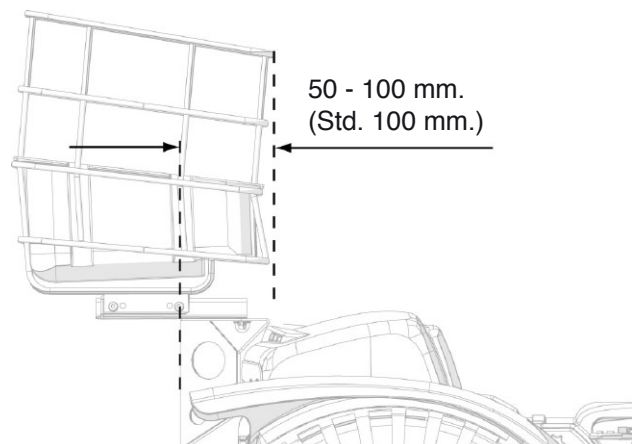

Vid montering kan bagagekorgens position justeras.

- Montera bagagekorgens fäste på chassifästet med de medföljande skruvarna (M6x16). Som standard monteras fästet i den bakersta hålbilden.

För att flytta bagagekorgens position framåt kan bagagekorgens fäste flyttas 1-2 steg framåt i hålbilden, varje steg förskjuter bagagekorgens position 25 mm.

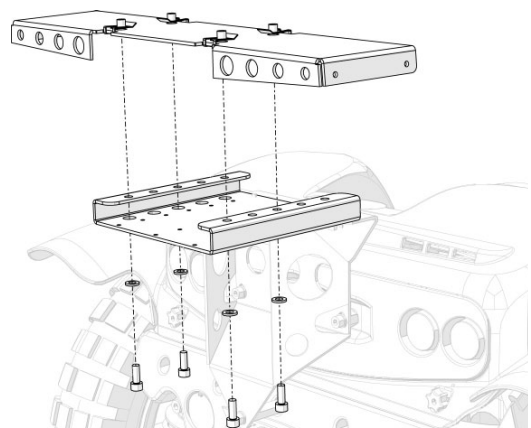

Montera bagagekorgens fäste på chassifästet.

Assembly Instruction

Document No. 247852	Revision A				
Production state SERIES					
Preform Date 2011-05-31	Preform By TSN	Approved Date 2011-05-31	Approved By GHT	Page 6	

6. Montera bagagekorgen på fästet, använd de medföljande skruvarna (M5x10) samt brickor.

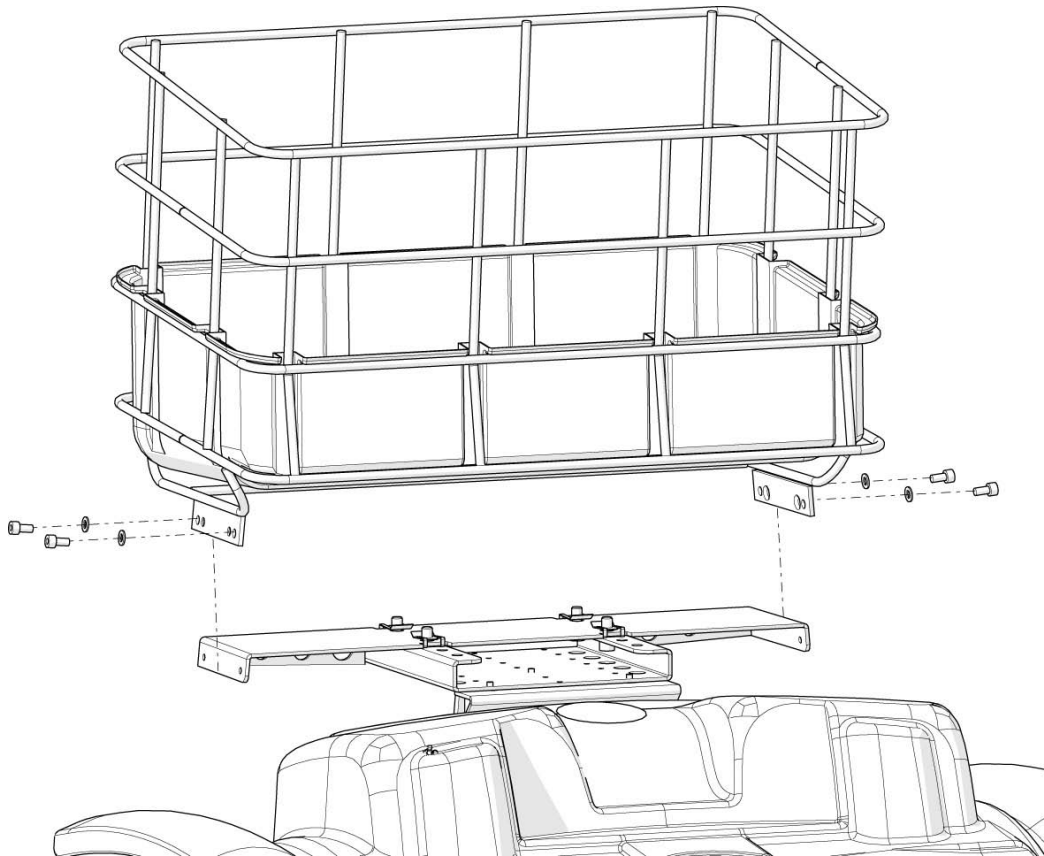

Montera bagagekorgen på fästet.