

permobil

RAM® Self-Leveling Cup Holder

Installation instructions



permobil

Overview

The following guide illustrates how to assemble and attach the RAM® Self-Leveling Cup Holder to the UniTrack rail underneath the armrest. Additional mounting positions can be achieved using a similar process.

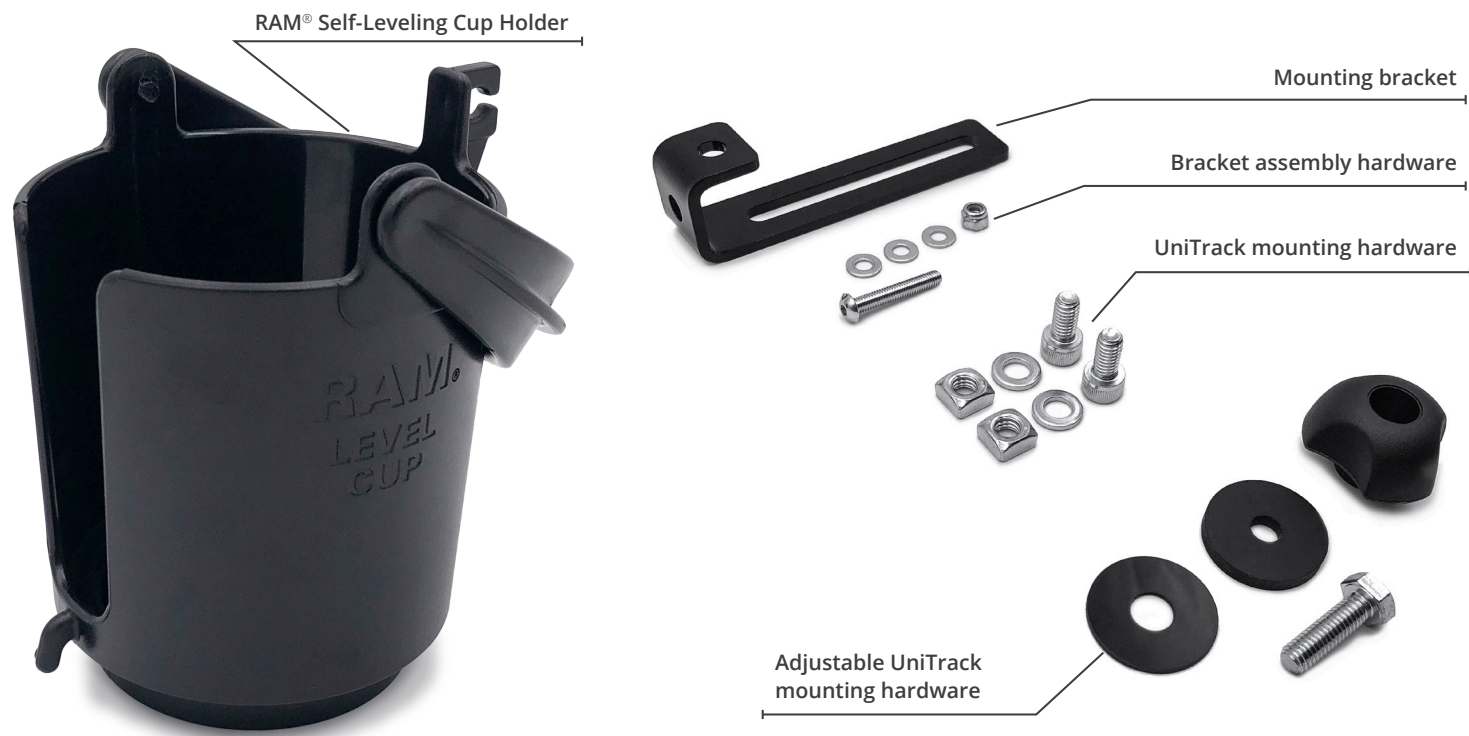

Cup holder assembly



UniTrack attachment



Adjustable UniTrack mounting



Warning: Mount cup holder within the widest point of the chair to avoid hitting objects.

Caution: Take care to avoid spills when storing hot beverages in the holder.

Caution: Permobil accepts no liability for any damage or destruction to any personal property contained within or used in conjunction with the RAM® Self-Leveling Cup Holder.